

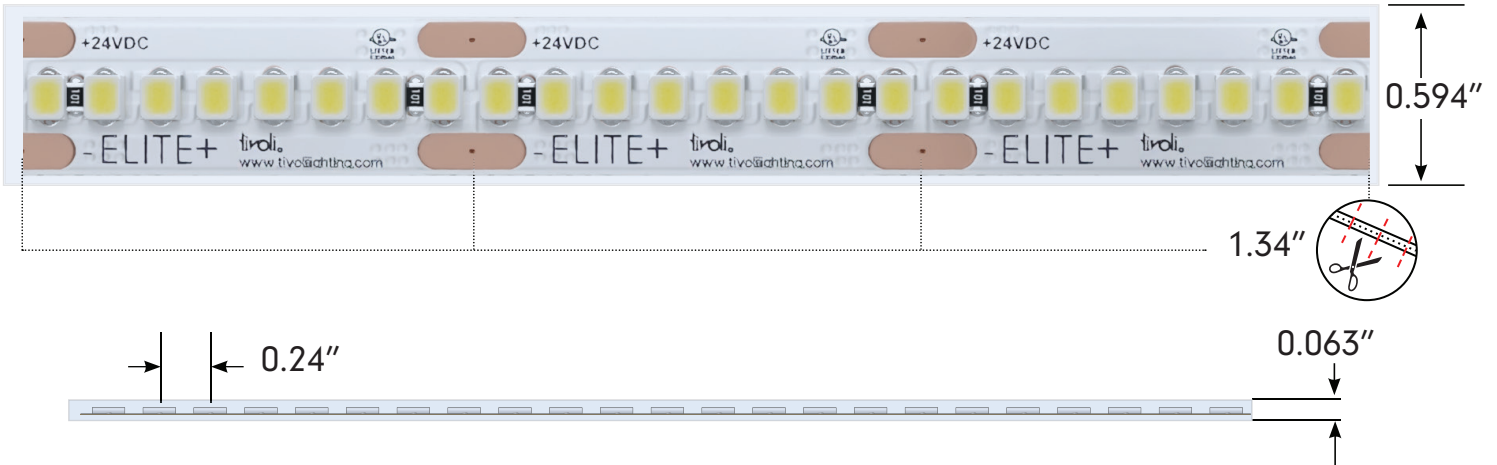

Project: _____ TYPE: _____

- Silicone sleeved for outdoor rating
- Multiple intensities to choose from
- Low bin tolerance with a 1.5 Step McAdam Elipse standard
- High efficacy value
- Includes Tivoli's eXo shield coating
- Factory soldered lead wire
- Standard IP67 wet rated and IP54 damp location available
- Multiple mounting channel options
- Large range of available Kelvin temperatures
- Low lead times
- 4oz. Copper Trace
- 3 Year warranty

Dimensions





Order Guide

PRODUCT CODE	INTENSITY	INSTALL	LED COLOR	VOLTAGE
TPLEP		O		24
TPLEP = TivoTape ELITE Plus+	XLB = Extra Low Brightness LB = Low Brightness SB = Standard Brightness HO = High Output	O = Outdoor	18 = 1800K 22 = 2200K 24 = 2400K 27 = 2700K 30 = 3000K 35 = 3500K 40 = 4000K 50 = 5000K	24 = 24V DC

Specification

XLB Low Brightness									LB Low Brightness								
Kelvin Temperature	1800K	2200K	2400K	2700K	3000K	3500K	4000K	5000K	Kelvin Temperature	1800K	2200K	2400K	2700K	3000K	3500K	4000K	5000K
Lumens/ft	47	60	60	73	76	72	85	76	Lumens/ft	164	155	156	188	203	186	223	187
Efficacy (Lm/W)	94	119	120	145	151	143	168	151	Efficacy (Lm/W)	113	111	111	134	140	133	158	134
CRI	93.5	93.5	93.5	93.5	93.5	94	93.7	93.5	CRI	93.2	93	94	94	92.9	93	93.6	94
Measured Power W/ft	0.5	0.5	0.5	0.5	0.5	0.5	0.5	0.5	Measured Power W/ft	1.4	1.4	1.4	1.4	1.4	1.4	1.4	1.4
Listed Power W/ft.	0.6								Listed Power W/ft.	1.5							
Max Run	150'								Max Run	60'							

SB Standard Brightness									HO High Output								
Kelvin Temperature	1800K	2200K	2400K	2700K	3000K	3500K	4000K	5000K	Kelvin Temperature	1800K	2200K	2400K	2700K	3000K	3500K	4000K	5000K
Lumens/ft	299	373	376	454	469	444	463	454	Lumens/ft	426	533	544	646	668	634	658	643
Efficacy (Lm/W)	98	124	125	151	158	149	154	150	Efficacy (Lm/W)	98	124	126	150	157	148	153	149
CRI	93.2	92.6	93.2	92.7	93.4	94	93.4	94.1	CRI	93	93	93	93	93	92	93	94
Measured Power W/ft	3.0	3.0	3.0	3.0	2.97	2.5	3.0	3.0	Measured Power W/ft	4.3	4.3	4.3	4.25	4.26	4.3	4.3	4.3
Listed Power W/ft.	3.2								Listed Power W/ft.	4.5							
Max Run	29'								Max Run	20'							

Electrical	
Input Voltage	24V
Dimming	MLV/ELV/0-10V/DMX
Physical	
LED Package	2835
LEDs/ft	73
Adhesive	3M VHB Tape
Copper Trace	4 Ounce
Dimensions	0.594" (15mm)
Cut Increments	1.33" (34mm)
Operating Temperature	-40°F (-40°C) ~ +140°F (+60°C)
Certification and Testing	
Certification	UL Listed, CE
Lumen Maintenance (L70)	60,000 hrs
Binning Tolerance	1.5 Step MacAdam Elipse
Environment	IP67 Wet Location, Silicone Sleeved
Warranty	3 years

Power Leads and Jumpers Wiring Diagram

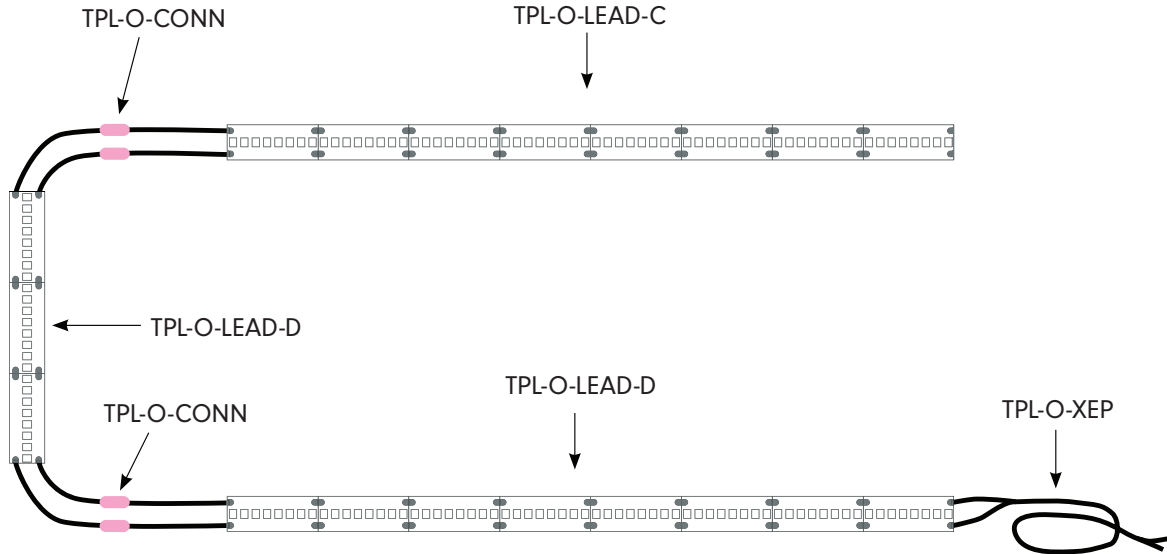

Power Leads and Jumpers (Installed by Tivoli's certified solderers)

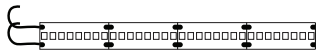

TPL-O-LEAD-C
 Lead to dead-end
 24" Standard 2 conductor 18AWG lead wire
 factory attached to one end of tape

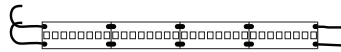

TPL-O-LEAD-D
 Lead to lead
 24" Standard 2 conductor 18AWG lead wire
 factory attached to both ends of tape

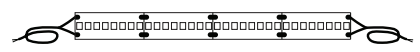

TPL-O-XEP
 Extra lead wire
 18AWG Lead wire extend lengths up to 20 ft max
 Sold per foot (not shipped as spooled wire)

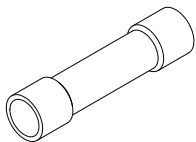

TPL-O-CONN
 18-22AWG Butt connectors
 Used to interconnect factory attached lead wires
 Sold individually (2 ea required per connection)

Compatible Extrusions

S Surface **SP** Suspended **R** Recessed

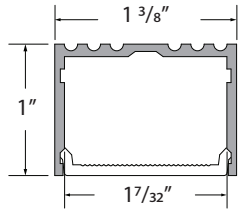

ALTN-CHAN-SLV-6.5
Anodized aluminum extrusion
available in 6.5' length

S **R**

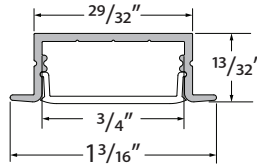

WRNR-CHAN-SLV-6.5
Anodized aluminum extrusion
available in 6.5' length

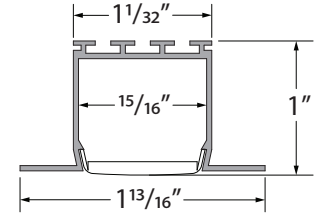

NOYS-CHAN-SLV-6.5
Anodized aluminum extrusion
available in 6.5' length

R **R**

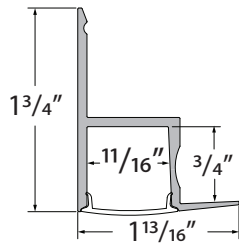

EDGE-CHAN-SLV-6.5
Anodized aluminum extrusion
available in 6.5' length

R

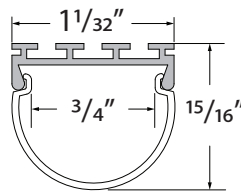

DOME-CHAN-SLV-6.5
Anodized aluminum extrusion
available in 6.5' length

S **R**

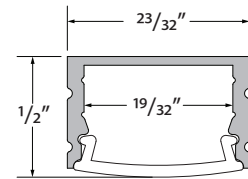

MOFT-CHAN-SLV-6.5
Anodized aluminum extrusion
available in 6.5' length

S



Recommended Power Supplies

INFINITY - MLV / ELV / 0-10V / PWM / TRIAC

DESCRIPTION	CAT NO	APPLICATION	PRIMARY VOLTAGE	SECONDARY VOLTAGE	CIRCUIT BREAKERS	MAX LOAD	MIN LOAD	CIRCUIT CAPACITY
Infinity Series Class 2 Transformer	INF-J-30-1-1.3-24	Indoor / Outdoor	100 - 277V AC	24V DC	1	30W	3W	1.3A
	INF-J-60-1-2.5-24				1	60W	6W	2.5A
	INF-J-96-1-4-24				1	96W	9W	4A
	INF-J-192-2-4-24				2	2x96W	2x9W	2x4A
	INF-J-288-3-4-24				3	3x96W	3x9W	3x4A

ER - JA8 W/ELITE 3000K

DESCRIPTION	CAT NO	APPLICATION	PRIMARY VOLTAGE	SECONDARY VOLTAGE	CIRCUIT BREAKERS	MAX LOAD	CIRCUIT CAPACITY
ER Series Class 2	ER-80-1-3.3-24-D	Indoor / Outdoor	100-277V AC 50/60 Hz	24V DC	1	80W	3.3A
ER Series Class 2 0-10V Dimming	ERG-80-24-DIM1-10						

ADNM - NON DIMMING

DESCRIPTION	CAT NO	APPLICATION	PRIMARY VOLTAGE	SECONDARY VOLTAGE	CIRCUIT BREAKERS	MAX LOAD	CIRCUIT CAPACITY
ADNM Series Class 2 Transformer	ADNM-90-1-4-24-D	Indoor / Outdoor	100-277V AC 50/60 HZ	24V DC	1	90W	3.75A
	ADNM-120-1-4-24-D				1	96W	4A
	ADNM-240-2-4-24-D				2	2x96W	2x4A
	ADNM-320-3-4-24-D				3	3x96W	3x4A

ADNM - 0-10V DIMMING

DESCRIPTION	CAT NO	APPLICATION	PRIMARY VOLTAGE	SECONDARY VOLTAGE	CIRCUIT BREAKERS	MAX LOAD	CIRCUIT CAPACITY
ADNM Series Class 2 Transformer	ADNM-90-1-4-24-DOT	Indoor / Outdoor	100-277V AC 50/60 HZ	24V DC	1	90W	3.75A
	ADNM-120-1-4-24-DOT				1	96W	4A
	ADNM-240-2-4-24-DOT				2	2x96W	2x4A
	ADNM-320-3-4-24-DOT				3	3x96W	3x4A

ADNM - DMX SINGLE ADDRESS

DESCRIPTION	CAT NO	APPLICATION	PRIMARY VOLTAGE	SECONDARY VOLTAGE	CIRCUIT BREAKERS	MAX LOAD	CIRCUIT CAPACITY
ADNM Series Class 2 Transformer	ADNM-90-1-4-24-DIN	Indoor / Outdoor	100-277V AC 50/60 Hz	24V DC	1	90W	3.75A
	ADNM-120-1-4-24-DIN				1	96W	4A
	ADNM-240-2-4-24-DIN				2	2x96W	2x4A
	ADNM-320-3-4-24-DIN				3	3x96W	3x4A

Recommended Power Supplies

ADNM - DMX MULTI ADDRESS

DESCRIPTION	CAT NO	APPLICATION	PRIMARY VOLTAGE	SECONDARY VOLTAGE	CIRCUIT BREAKERS	MAX LOAD	CIRCUIT CAPACITY
ADNM Series Class 2 Transformer	ADNM-240-2-4-24-DIN-2	Indoor / Outdoor	100-277V AC 50/60 Hz	24V DC	2	2x96W	2x4A
	ADNM-320-3-4-24-DIN-3				3	3x96W	3x4A

ADNM - DMX/DALI FLICKER-FREE FOR TV STUDIO

DESCRIPTION	CAT NO	APPLICATION	PRIMARY VOLTAGE	SECONDARY VOLTAGE	CIRCUIT BREAKERS	MAX LOAD	CIRCUIT CAPACITY
ADNM Series Class 2 Transformer	ADNM-120-1-4-24-DTV	Indoor / Outdoor	100-277V AC 50/60 HZ	24V DC	1	1x96W	1x4A
	ADNM-240-2-4-24-DTV				2	2x96W	2x4A
	ADNM-320-3-4-24-DTV				3	3x96W	3x4A

In-Wall Controls



TVOQ-1-WH
White

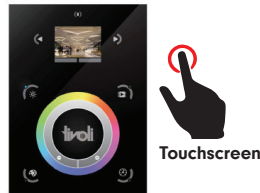

TVOQ-10-XX-7
XX = BK (Black), WH (White)

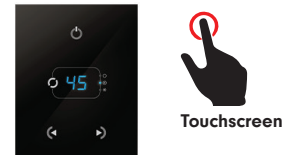

TVOQ-2-BK
Black